

WARNING

- Risk of fire. Turn off power before installation.
- Risk of electronic shock. Install only by certified electrician with gloves.
- To be used in indoor dry and damp location only.
- If the luminaire exhibits undesirable operation (buzzing, flickering, not working etc.) ,immediately turn off power, remove luminaire and contact manufacturer.
- Do not make mass installation before testing.



INSTALLATION FOR SURFACE MOUNTING

1. Disconnect or turn off power before installation.
2. If applicable: adjust the FlexWatt and/or FlexColor switches to desired wattage/lumen package and CCT.
*Note: that not all models have these adjustments. Check your part # and product specification sheet for more details.
*Note: if applicable, lock out the adjustment switches to meet DLC requirements.
3. Remove fixture lens, see step ①.
4. Remove existing sockets/ballast, see step ②.
5. Adjust LED boards as desired to uniformly illuminate lens, see step ③.
6. Using provided brass nut, tighten LEDCR plate onto fixture, see step ④.
7. Make the electrical connection to the fixture in accordance with local electrical code. Make all necessary wiring connections, observing proper voltage and polarity. See step ⑤.
8. Reattached the lens to the base, make sure the lens is well attached. See step ⑥.
9. Connect or turn on the power, the light will be on.
10. Adjust settings of the motion sensor (OCC) if desired. See separate instruction sheet for details.

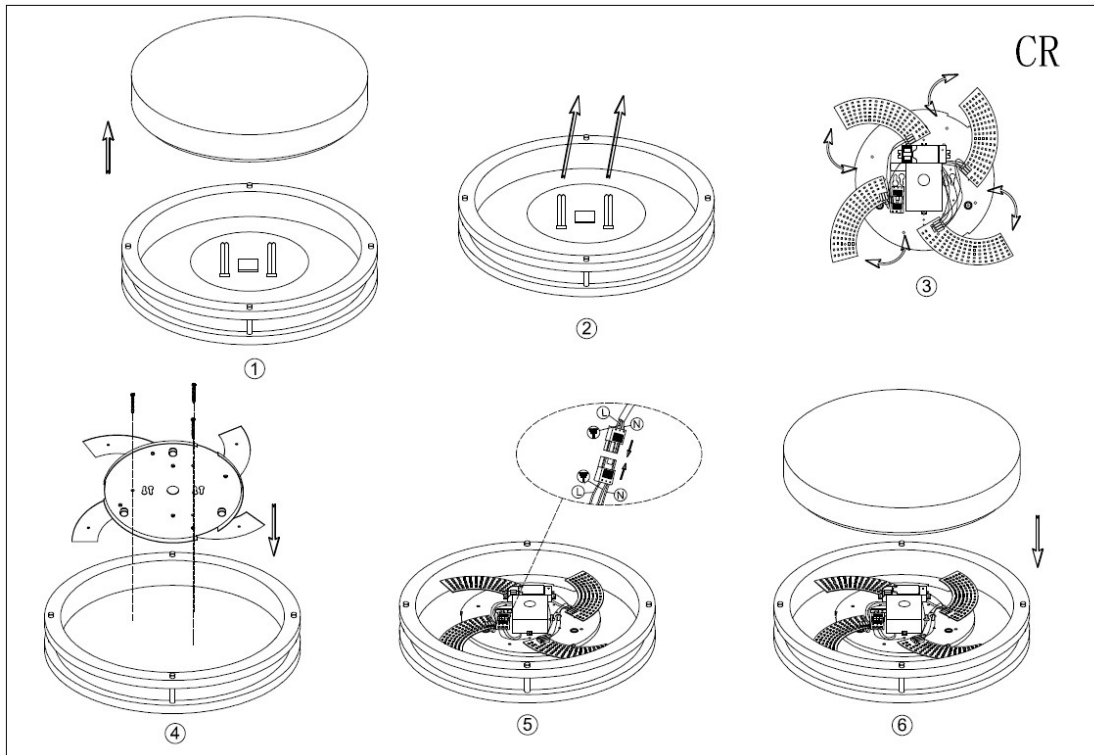

Printed on paper that is FSC® Certified, SF® Certified Sourcing and Rainforest Alliance Certified™. 10% post consumer recycled content and certified fiber, it's the optimal environmental choice, because RemPhos cares.

May be protected under the following US patents - US 8,106,569 | US 8,882,298 | Additional patents pending. Information is subject to change without notice.

LEDCR G2 + LEDSR G2 LED RETROFIT KIT | FLEXWATT + FLEXCOLOR + FLEXCONTROL



HOW DOES IT WORK?

Our exclusive LED driver is designed to operate at 90%+ efficiency at each wattage setting. Standard drivers would have much lower efficiency as low as 60% and would result in poor performance and reduced efficacy.

WHAT ARE THE WATTAGE CHOICES?

Please reference this table and the ordering guide on the last page of the cut sheet.

FLEXWATT TURN DIAL POSITION				
STYLE	0	1	2	3
LEDCR	6W (8L)	10W (14L)	16W (23L)	22W (31L)
LEDSR	6W (8L)	10W (14L)	12W (17L)	15W (21L)

HOW EASY IS IT TO SET?

Simply slide off the driver door, adjust the 4-position turn dial with a small, flat-head screw driver, and replace the door. Quick and easy. Can be "locked-out" to prevent field-adjustability if desired.

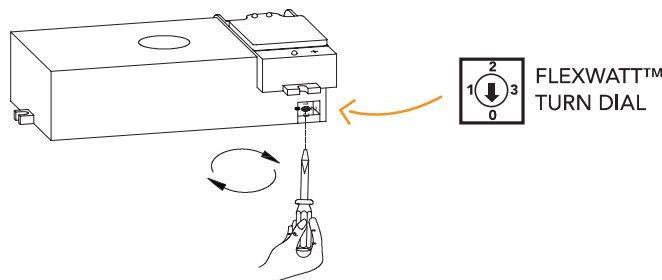

HOW DOES IT WORK?

We select the highest efficacy, multiple color LED diodes from quality suppliers, and mount them on the same circuit board. A proprietary LED binning process ensures color consistency between fixtures. The FlexColor technology controller ensures the correct color is selected, every time.

WHAT ARE THE COLOR CHOICES?

3000k, 3500k and 4000k. Please reference this table and the ordering guide on the last page of the cut sheet.

FLEXCOLOR SLIDE SWITCH POSITION		
TOP	MIDDLE	BOTTOM
3000K	3500K	4000K

HOW EASY IS IT TO SET?

Adjust the 3-position slide switch with your finger. Quick and easy. Can be "locked-out" to prevent field-adjustability if desired.

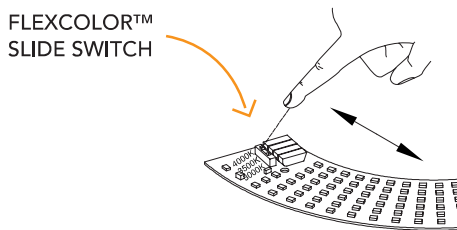

12v Aux - 50mA
10V DIM-to-OFF

